

TABLE 1. DASH NUMBERS AND DIMENSIONS

SIZE NUMBER	7/0			6/0			5/0			4/0			3/0			2/0		
	DIA NOM	DIA LARG MAX	DIA MIN	DIA NOM	DIA LARG MAX	DIA MIN	DIA NOM	DIA LARG MAX	DIA MIN	DIA NOM	DIA LARG MAX	DIA MIN	DIA NOM	DIA LARG MAX	DIA MIN	DIA NOM	DIA LARG MAX	DIA MIN
7/0	.0625	.0638	.0618	.0780	.0793	.0773	.0940	.0953	.0933	.1090	.1103	.1083	.1250	.1263	.1243	.1410	.1423	.1403
6/0	.0625	.0638	.0618	.0780	.0793	.0773	.0940	.0953	.0933	.1090	.1103	.1083	.1250	.1263	.1243	.1410	.1423	.1403
5/0	.0625	.0638	.0618	.0780	.0793	.0773	.0940	.0953	.0933	.1090	.1103	.1083	.1250	.1263	.1243	.1410	.1423	.1403
4/0	.0625	.0638	.0618	.0780	.0793	.0773	.0940	.0953	.0933	.1090	.1103	.1083	.1250	.1263	.1243	.1410	.1423	.1403
3/0	.0625	.0638	.0618	.0780	.0793	.0773	.0940	.0953	.0933	.1090	.1103	.1083	.1250	.1263	.1243	.1410	.1423	.1403
2/0	.0625	.0638	.0618	.0780	.0793	.0773	.0940	.0953	.0933	.1090	.1103	.1083	.1250	.1263	.1243	.1410	.1423	.1403

DASH NUMBERS FOR ALLOY STEEL CONTAINING THE LETTER "A" INDICATE ULTIMATE TENSILE STRENGTH 125,000 TO 145,000 psi. DASH NUMBERS FOR ALLOY STEEL WITHOUT THE LETTER "A" INDICATE MS24692B MINIMUM ULTIMATE TENSILE STRENGTH 106,000 psi AND SHALL NOT BE USED FOR HIGH DESIGN.

SIZE NUMBER	0			1			2			3			4			5		
	DIA NOM	DIA LARG MAX	DIA MIN	DIA NOM	DIA LARG MAX	DIA MIN	DIA NOM	DIA LARG MAX	DIA MIN	DIA NOM	DIA LARG MAX	DIA MIN	DIA NOM	DIA LARG MAX	DIA MIN	DIA NOM	DIA LARG MAX	DIA MIN
0	.1540	.1573	.1553	.1720	.1733	.1713	.1930	.1943	.1923	.2190	.2203	.2183	.2500	.2513	.2493	.2890	.2903	.2883
1	.1540	.1573	.1553	.1720	.1733	.1713	.1930	.1943	.1923	.2190	.2203	.2183	.2500	.2513	.2493	.2890	.2903	.2883
2	.1540	.1573	.1553	.1720	.1733	.1713	.1930	.1943	.1923	.2190	.2203	.2183	.2500	.2513	.2493	.2890	.2903	.2883
3	.1540	.1573	.1553	.1720	.1733	.1713	.1930	.1943	.1923	.2190	.2203	.2183	.2500	.2513	.2493	.2890	.2903	.2883
4	.1540	.1573	.1553	.1720	.1733	.1713	.1930	.1943	.1923	.2190	.2203	.2183	.2500	.2513	.2493	.2890	.2903	.2883
5	.1540	.1573	.1553	.1720	.1733	.1713	.1930	.1943	.1923	.2190	.2203	.2183	.2500	.2513	.2493	.2890	.2903	.2883

DASH NUMBERS FOR ALLOY STEEL CONTAINING THE LETTER "A" INDICATE ULTIMATE TENSILE STRENGTH 125,000 TO 145,000 psi. DASH NUMBERS FOR ALLOY STEEL WITHOUT THE LETTER "A" INDICATE MS24692B MINIMUM ULTIMATE TENSILE STRENGTH 106,000 psi AND SHALL NOT BE USED FOR HIGH DESIGN.

ENTIRE STANDARD REVISED

P A ARMY-AR <small>Other Cont</small> NAVY-OS AIR FORCE-99	INTERNATIONAL INTEREST	TITLE PIN, TAPERED, PLAIN	MILITARY STANDARD MS24692
PROCUREMENT SPECIFICATION MIL-P-16610	SUPERSEDES AN385, BFCX1, BFCX2, BFCX2.1 AND IN PART BFCX2.2	PAGE OF 6	

USER ACTIVITIES:
ARMY-AT, ME
NAVY-AS, MC, SH

REVIEWER ACTIVITIES:
ARMY-AV
DLA-IS

DISTRIBUTION STATEMENT A. Approved for public release; distribution is unlimited.
This military standard is approved for use by all Departments and Agencies of the Department of Defense without limitation for all new engineering and design applications and for repetitive use shall be made from this document when applicable.

TABLE I. DASH NUMBERS AND DIMENSIONS - CONTINUED

SIZE NUMBER	6			7			8			9			10		
DIA NOM	.3410			.4090			.4920			.5910			.7060		
DIA LARGZ MAX	.3423			.4103			.4933			.5923			.7073		
DIA MIN	.3403			.4083			.4913			.5903			.7053		
R RADII	.341			.409			.492			.591			.706		
L LENGTH	DASH NUMBER			DASH NUMBER			DASH NUMBER			DASH NUMBER			DASH NUMBER		
	CAR STL	ALY STL	CRS	CAR STL	ALY STL	CRS	CAR STL	ALY STL	CRS	CAR STL	ALY STL	CRS	CAR STL	ALY STL	CRS
1.250	328	329A	330												
1.500	331	332A	333												
1.750	334	335A	336												
2.000	337	338A	339	364	365A	366	391	392A	393						
2.250	340	341A	342	367	368A	369	394	395A	396						
2.500	343	344A	345	370	371A	372	397	398A	399						
2.750	346	347A	348	373	374A	375	400	401A	402	430	431A	432			
3.000	349	350A	351	376	377A	378	403	404A	405	433	434A	435			
3.250	352	353A	354	379	380A	381	406	407A	408	436	437A	438			
3.500	355	356A	357	382	383A	384	409	410A	411	439	440A	441	469	470A	471
3.750	358	359A	360	385	386A	387	412	413A	414	442	443A	444	472	473A	474
4.000	361	362A	363	388	389A	390	415	416A	417	445	446A	447	475	476A	477
4.250							418	419A	420	448	449A	450	478	479A	480
4.500							421	422A	423	451	452A	453	481	482A	483
4.750							424	425A	426	454	455A	456	484	485A	486
5.000							427	428A	429	457	458A	459	487	488A	489
5.250										460	461A	462	490	491A	492
5.500										463	464A	465	493	494A	495
5.750										466	467A	468	496	497A	498
6.000													499	500A	501

1/ DASH NUMBERS FOR ALLOY STEEL CONTAINING THE LETTER "A" INDICATE ULTIMATE TENSILE STRENGTH 125,000 TO 145,000 psi. DASH NUMBERS FOR ALLOY STEEL WITHOUT THE LETTER "A" INDICATE MINIMUM ULTIMATE TENSILE STRENGTH 106,000 psi AND SHALL NOT BE USED FOR NEW DESIGN.

REQUIREMENTS:

- MATERIAL:**
 - A - CARBON STEEL PINS SHALL BE MANUFACTURED IN ACCORDANCE WITH ASTM A108 AND SHALL HAVE A MINIMUM ULTIMATE TENSILE STRENGTH OF 55,000 psi.
 - B - ALLOY STEEL PINS SHALL BE MANUFACTURED IN ACCORDANCE WITH ASTM A311 AND SHALL HAVE AN ULTIMATE TENSILE STRENGTH OF 125,000 TO 145,000 psi.
 - C - CORROSION RESISTANT STEEL PINS SHALL BE MANUFACTURED IN ACCORDANCE WITH ASTM A582 AND SHALL HAVE A MINIMUM TENSILE STRENGTH OF 70,000 psi.
- PRODUCTIVE FINISH:**
 - CARBON AND ALLOY STEEL PINS: WHEN SPECIFIED, CADMIUM PLATE IN ACCORDANCE WITH QQ-P-416, TYPE II, CLASS 2 OR MIL-C-81562, TYPE II, CLASS 2.
 - CORROSION RESISTANT STEEL PINS: CLEANED, DEOILED AND PASSIVATED IN ACCORDANCE WITH ASTM A380.
- DRILLED HOLES:** "E" DIAMETER SHALL BE .024 ± .005 FOR SIZES 7/0 THROUGH 4/0 AND .046 ± .005 FOR SIZES 3/0 THROUGH 6. SIZES 7 THROUGH 10 SHALL NOT BE DRILLED. CORROSION RESISTANT STEEL PINS SHALL NOT BE DRILLED.
- PART NUMBER:** THE PART NUMBER SHALL CONSIST OF THE BASIC NS NUMBER, FOLLOWED BY A DASH NUMBER TAKEN FROM TABLE I AND A LETTER DESIGNATION FOR DRILLED PINS, CADMIUM PLATED PINS OR DRILLED AND CADMIUM PLATED PINS.

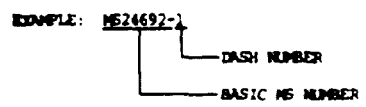

MS24692-1 INDICATES: PIN, TAPERED, PLAIN; SIZE NUMBER 7/0; DIAMETER .0625; LENGTH .375; CARBON STEEL.

OTHER ACTIVITIES:
 ARMY - AT
 NAVY - AS, MC, SH

REVIEWER ACTIVITIES:
 ARMY - AV
 DLA - IS

This military standard is approved for use by all Departments and Agencies of the Department of Defense. Selection for all new engineering and design applications and for repetitive use shall be made from this document where APPLICABLE.

P. A. ARMY-AR Other Code NAVY-OS AIR FORCE-99	INTERNATIONAL INTEREST	TITLE PIN, TAPERED, PLAIN	MILITARY STANDARD
			MS24692
PROCUREMENT SPECIFICATION MIL-P-15610	SUPERSEDES: AN385, BFCX1, BFCX2, BFCX2 I AND IN PART BFCX2.2	PAGE 2 OF 6	

4.5 AND 6
 REVISED 29 JUL 60
 FOR CHANGES SEE PAGES

OTHER ACTIVITIES
ARMY - AT
NAVY - AS, MC, SH

REVISED ACTIVITIES
ARMY - AV
DLA - IS

This military standard is approved for use by all Departments and Agencies of the Department of Defense.
Selection for all new engineering and design applications and for replacement use shall be made from this document which applies only to the

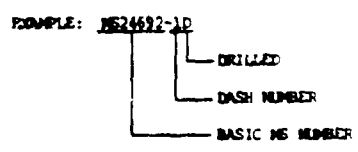

MS24692-1D INDICATES: PIN, TAPERED, PLAIN; SIZE NUMBER 7/0; DIAMETER .0625; LENGTH .375; CARBON STEEL, DRILLED.

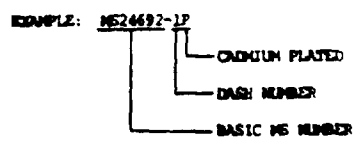

MS24692-1P INDICATES: PIN, TAPERED, PLAIN; SIZE NUMBER 7/0; DIAMETER .0625; LENGTH .375; CARBON STEEL, CADMIUM PLATED.

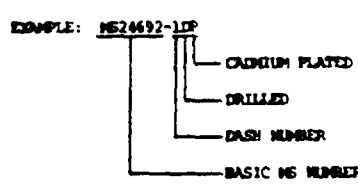

MS24692-1DP INDICATES: PIN, TAPERED, PLAIN; SIZE NUMBER 7/0; DIAMETER .0625; LENGTH .375; CARBON STEEL, DRILLED, CADMIUM PLATED.

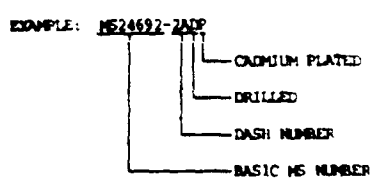

MS24692-2ADP INDICATES: PIN, TAPERED, PLAIN; SIZE NUMBER 7/0; DIAMETER .0625; LENGTH .375; ALLOY STEEL, DRILLED, CADMIUM PLATED MINIMUM ULTIMATE TENSILE STRENGTH 125,000 TO 145,000 psi.

NOTES:

1. ALL DIMENSIONS ARE IN INCHES. TOLERANCES $\pm .010$ UNLESS OTHERWISE SPECIFIED.
2. TO OBTAIN THE DIAMETER OF THE SMALL END, MULTIPLY THE LENGTH BY $.02083$ AND SUBTRACT THE PRODUCT FROM THE LARGE END NOMINAL DIAMETER.
3. IN THE EVENT OF A CONFLICT BETWEEN THE TEXT OF THIS STANDARD AND THE REFERENCES CITED HEREIN, THE TEXT OF THIS STANDARD SHALL TAKE PRECEDENCE.
4. REFERENCED GOVERNMENT (OR NON-GOVERNMENT) DOCUMENTS OF THE ISSUE LISTED IN THAT ISSUE OF THE DEPARTMENT OF DEFENSE INDEX OF SPECIFICATIONS AND STANDARDS (DODISS) SPECIFIED IN THE SOLICITATION FORM A PART OF THIS STANDARD TO THE EXTENT SPECIFIED HEREIN.

APPROVED 29 JUL 60 REVISED ① FOR CHANGES SEE PAGES 1, 2, 3, 4, 5 AND 6

P. A. ARMY - AR Other Code NAVY - OS AIR FORCE - 99	INTERNATIONAL INTEREST	TITLE PIN, TAPERED, PLAIN	MILITARY STANDARD	
			MS24692	
PROCUREMENT SPECIFICATION MIL - P - 16610	SUPERSEDES: AN385, BFCX1, BFCX2, BFCX2.1 AND IN PART BFCX2.2	PAGE 3 OF 6		

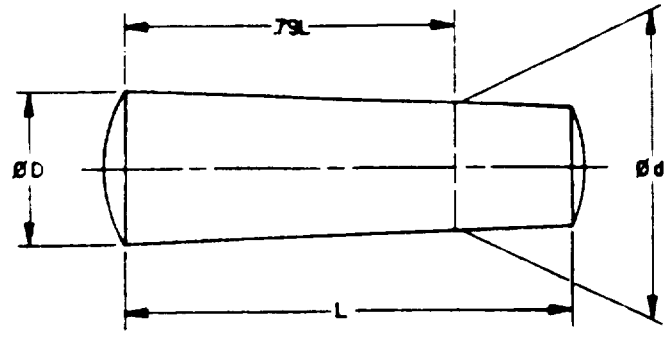

USER ACTIVITIES:
ARMY - AT, ME
NAVY - AS, MC, SH

REVERSE ACTIVITIES:
ARMY - AV
DLA - IS

This military standard is approved for use by all Departments and Agencies of the Department of Defense. Selection for all new engineering and design applications and for repetitive use shall be made from this document. WHERE APPLICABLE.

TABLE 11-A

SHEAR LOAD "P" IN POUNDS - CARBON STEEL 1/2, 2/3, 3																	
L	7/0	6/0	5/0	4/0	3/0	2/0	0	1	2	3	4	5	6	7	8	9	10
.375	49	79	120	165	210	275	340										
.500	65	75	115	155	210	275	330	410									
.625	42	71	110	150	205	265	320	395	510	670							
.750	38	66	105	145	195	255	310	385	500	650							
.875	35	62	98	140	190	250											
1.000	12	59	93	130	185	240	305	375	490	640	850	1160					
1.250	27	5	83	120	170	225	285	355	460	610	820	1130	1610				
1.500	22		74	110	155	210	270	340	440	590	790	1090	1560				
1.750							250	320	420	560	760	1060	1520				
2.000					145	195	235	300	400	540	740	1020	1480	2210	3300		
2.250								285	380	520	710	990	1440	2170	3240		
2.500								265	360	490	680	960	1480	2120	3180		
2.750								250	340	470	650	930	1370	2070	3130		
3.000								235	320	450	630	900	1330	2020	3070	4670	
3.250													1290	1980	3010	4600	6590
3.500													1260	1930	2950	4640	6540
3.750													1220	1890	2900	4590	6510
4.000													1180	1840	2840	4520	6420
4.250															2790	4250	6340
4.500															2730	4190	6260
4.750															2680	4120	6180
5.000															2630	4050	6100
5.250																3990	6020
5.500																3930	5940
5.750																3860	5860
6.000																	5780

TABLE 11-B

SHEAR LOAD "P" IN POUNDS - ALLOY STEEL 1/2, 2/3, 3																	
L	7/0	6/0	5/0	4/0	3/0	2/0	0	1	2	3	4	5	6	7	8	9	10
.375	115	190	285	390	500	650	800										
.500	110	180	270	375	500	650	800	960									
.625	100	165	255	355	485	625	785	940	1200	1580							
.750	90	160	245	345	470	605	760	940	1200	1540							
.875	85	150	230	330	450	590	735	920	1170	1540							
1.000	80	135	220	315	430	570	725	895	1140	1520	2020	2640					
1.250	65	120	195	285	405	535	675	850	1100	1460	1950	2750	3810				
1.500	50	105	180	260	370	500	640	810	1040	1400	1890	2670	3710				
1.750					340	460	595	765	990	1340	1820	2600	3620				
2.000						560	715	950	1280	1750	2510	3520	5250	7830			
2.250								680	900	1230	1690	2420	3430	5130	7680		
2.500								630	850	1170	1620	2350	3330	5040	7560		
2.750								600	805	1120	1560	2280	3230	4910	7410	11100	
3.000								560	760	1070	1500	2190	3160	4800	7290	10900	
3.250													3080	4700	7140	10740	
3.500													2980	4560	7010	10600	15640
3.750													2890	4420	6880	10420	15440
4.000													2810	4380	6750	10250	15270
4.250															6620	10100	15050
4.500															6490	9940	14860
4.750															6360	9780	14670
5.000															6240	9620	14470
5.250																9470	14280
5.500																9340	14100
5.750																9160	13900
6.000																	13720

3, 3, 4, 5 AND 6

APPROVED 29 JUL 60 REVISED FOR CHANGES SEE PAGE

ARMY - AR Other Cost NAVY - OS AIR FORCE - 99	INTERNATIONAL INTEREST	TITLE PIN, TAPERED, PLAIN	MILITARY STANDARD MS24692
PROCUREMENT SPECIFICATION MIL - P - 16610	SUPERSEDES AN385, BFCX1, BFCX2, BFCX2.1 AND IN PART BFCX2.2	PAGE 4 OF 6	

TABLE II-C

SHEAR LOAD "P" IN POUNDS - CORROSION RESISTANT STEEL 1/2, 3/4, 1

L	7/0	6/0	5/0	4/0	3/0	2/0	0	1	2	3	4	5	6	7	8	9	10
.375	70	115	175	240													
.500	65	110	165	230	305	395	490										
.625	60	100	155	220	295	385	480	590									
.750	56	96	150	210	285	375	470	580	780	970							
.875	51	90	140	200	275	360	450	560	720	950							
1.000	47	84	135	190	265	350	440	550	700	930	1240	1680					
1.250	39	73	120	175	245	325	410	520	670	890	1190	1630	2330				
1.500	31	63	105	160	225	305	390	490	640	850	1150	1580	2270				
1.750					210	285	365	460	610	820	1110	1530	2210				
2.000							340	440	580	780	1070	1490	2150	3210	4780		
2.250								410	550	750	1030	1440	2100	3140	4700		
2.500								385	520	720	990	1390	2040	3070	4620		
2.750								360	490	690	950	1350	1980	3000	4530	6770	
3.000								340	470	650	910	1300	1930	2930	4450	6660	
3.250													1870	2870	4370	6560	
3.500													1820	2800	4280	6460	9560
3.750													1770	2740	4200	6360	9430
4.000													1720	2670	4120	6270	9310
4.250															4040	6170	9190
4.500															3970	6070	9080
4.750															3890	5970	8960
5.000															3810	5880	8840
5.250																5780	8720
5.500																5690	8610
5.750																5600	8490
6.000																	8380

- 1/ THESE TABLES ARE BASED ON MAXIMUM ALLOWABLE SHEAR STRESSES OF 20,000 psi FOR CARBON STEEL, 47,500 psi FOR ALLOY STEEL AND 29,000 psi FOR CORROSION RESISTANT STEEL. EACH IS ASSUMED TO OCCUR AT "d" DIAMETER. (SEE SHEET 4)
- 2/ THESE VALUES ARE BASED ON THE FOLLOWING FORMULA:

$$\text{SHEAR LOAD: } P = \frac{\pi}{4} d^2 \times S \quad \text{EXAMPLE: } .7854d^2 \times 20,000$$
- 3/ FOR DESIGN INFORMATION ONLY.

TABLE III.

RECOMMENDED PIN SIZE BY SHAFT DIAMETER FOR AVERAGE CONDITIONS

SIZE NUMBER	7/0	6/0	5/0	4/0	3/0	2/0	0	1	2	3	4	5	6	7	8	9	10
DIAMETER OF SHAFT	.188	.219	.250	.312	.375	.438	.500	.562	.625	.750	.812	.875	1.000	1.250	1.500	2.000	2.500

OVER ACTIVITIES
 ARMY - AT, ME
 NAVY - AS, MC, SH

REVIEWER ACTIVITIES
 ARMY - AV
 DLA - IS

This military standard is approved for use by all Departments and Agencies of the Department of Defense. Section for all new engineering and design applications and for repetitive use shall be made from this document WHEN APPLICABLE.

APPROVED 29 JUL 60 REVISION (D) FOR CHANGES SEE PAGES 1, 2, 3, 4, 5 AND 6

P. A ARMY - AR NAVY - OS AIR FORCE - 99	INTERNATIONAL INTEREST	TITLE PIN, TAPERED, PLAIN	MILITARY STANDARD
			MS24692
PROCUREMENT SPECIFICATION MIL - P-10610	SUPERSEDES AN385, BFCX1, BFCX2, BFCX2.1 AND IN PART BFCX2.2	PAGE 5 OF 6	

INTERCHANGEABILITY

THE PINS COVERED BY DASH NUMBERS GIVEN IN AN385 ARE CANCELED AFTER 30 AUGUST 1973 AND SUPERSEDED BY PINS COVERED BY DASH NUMBERS GIVEN IN MS24692. THE CANCELED PINS SHOULD BE USED UNTIL EXISTING STOCKS ARE DEPLETED. USE ONLY THE SUPERSEDING PINS OF MS24692 FOR NEW DESIGN AND ENGINEERING. REPLACEMENT SHALL BE IN ACCORDANCE WITH THIS TABLE AND USING THE FOLLOWING CODING:

- A. FOR AN385 DRILLED PIN WITH "H" BEFORE THE FIRST DASH NUMBER. EXAMPLE: AN385H70-3 SUPERSEDED BY MS24692-10 AND AN385A70-3 SUPERSEDED BY MS24692-2AD.
- B. FOR AN385 CROMIUM PLATED PIN WITH "P" BEFORE THE SECOND DASH NUMBER. EXAMPLE: AN385-70P3 SUPERSEDED BY MS24692-1P AND AN385A70P3 SUPERSEDED BY MS24692-2AP.
- C. FURTHER EXAMPLES: AN385H70P3 SUPERSEDED BY MS24692-1DP AND AN385A70P3 SUPERSEDED BY MS24692-2AP.
- D. SAME AS 1/.

TABLE IV.

DASH NUMBER		DASH NUMBER		DASH NUMBER		DASH NUMBER		DASH NUMBER		DASH NUMBER	
CANC AN385	SUPSD BY MS24692D	CANC AN385	SUPSD BY MS24692D	CANC AN385	SUPSD BY MS24692D	CANC AN385	SUPSD BY MS24692D	CANC AN385	SUPSD BY MS24692D	CANC AN385	SUPSD BY MS24692D
70-3	1	50-4	52	30-6	103	10-10	160	2-14	223	4-16	286
A70-3	2A	A50-4	53A	A30-6	104A	A10-10	161A	A2-14	224A	A4-16	287A
70-4	4	50-5	55	30-7	106	10-12	163	2-16	226	4-18	289
A70-4	5A	A50-5	56A	A10-7	107A	A10-12	164A	A2-16	227A	A4-18	290A
70-5	7	50-6	58	30-8	109	10-14	166	2-18	229	4-20	292
A70-5	8A	A50-6	59A	A30-8	110A	A10-14	167A	A2-18	230A	A4-20	293A
70-6	10	50-7	61	30-10	112	10-16	169	2-20	232	4-22	295
A70-6	11A	A50-7	62A	A30-10	113A	A10-16	170A	A2-20	233A	A4-22	296A
70-7	13	50-8	64	30-12	115	1-5	172	3-7	244	4-24	298
A70-7	14A	A50-8	65A	A30-12	116A	A1-5	173A	A3-7	245A	A4-24	299A
70-8	16	50-10	67	30-14	118	1-6	175	3-8	247	5-14	310
A70-8	17A	A50-10	68A	A30-14	119A	A1-6	176A	A3-8	248A	A5-14	311A
70-10	19	50-12	70	20-5	124	1-7	178	3-10	250	5-16	313
A70-10	20A	A50-12	71A	A20-5	125A	A1-7	179A	A3-10	251A	A5-16	314A
70-12	22	40-3	73	20-6	127	1-8	181	3-12	253	5-18	316
A70-12	23A	A40-3	74A	A20-6	128A	A1-8	182A	A3-12	254A	A5-18	317A
60-3	25	40-4	76	20-7	130	1-10	184	3-14	256	5-20	319
A60-3	26A	A40-4	77A	A20-7	131A	A1-10	185A	A3-14	257A	A5-20	320A
60-4	28	40-5	79	20-8	133	1-12	187	3-16	259	5-22	322
A60-4	29A	A40-5	80A	A20-8	134A	A1-12	188A	A3-16	260A	A5-22	323A
60-5	31	40-6	82	20-10	136	1-14	190	3-18	262	5-24	325
A60-5	32A	A40-6	83A	A20-10	137A	A1-14	191A	A3-18	263A	A5-24	326A
60-6	34	40-7	85	20-12	139	1-16	193	3-20	265	6-16	337
A60-6	35A	A40-7	86A	A20-12	140A	A1-16	194A	A3-20	266A	A6-16	338A
60-7	37	40-8	88	20-14	142	2-6	208	3-22	268	6-18	340
A60-7	38A	A40-8	89A	A20-14	143A	A2-6	209A	A3-22	269A	A6-18	341A
60-8	40	40-10	91	10-5	148	2-7	211	3-24	271	6-20	343
A60-8	41A	A40-10	92A	A10-5	149A	A2-7	212A	A3-24	272A	A6-20	344A
60-10	43	40-12	94	10-6	151	2-8	214	4-12	280	6-22	346
A60-10	44A	A40-12	95A	A10-6	152A	A2-8	215A	A4-12	281A	A6-22	347A
60-12	46	30-4	97	10-7	154	2-10	217	4-14	283	6-24	349
A60-12	47A	A30-4	98A	A10-7	155A	A2-10	218A	A4-14	284A	A6-24	350A
50-3	49	30-5	100	10-8	157	2-12	220				
A50-3	50A	A30-5	101A	A10-8	158A	A2-12	221A				

USER ACTIVITIES
ARMY - AT
NAVY - AS, MC, SH

REVISOR ACTIVITIES
ARMY - AV
DLA - IS

This military standard is approved for use by all Departments and Agencies of the Department of Defense. Substitution for all new engineering and design applications and for repetitive use shall be made from this document under APPLICABLE.

P. A. ARMY - AR NAVY - OS AIR FORCE - 99	INTERNATIONAL INTEREST	TITLE PIN, TAPERED, PLAIN	MILITARY STANDARD
			MS24692
PROCUREMENT SPECIFICATION MIL - P - 16810	SUPERSEDES AN385, BFCX1, BFCX2, BFCX2.1 AND IN PART BFCX2.2	PAGE 6 OF 6	5315-0422

APPROVED 29 JUL 60 REVISED FOR CHANGES SEE PAGES 1, 2, 3, 4, 5 AND 6