

IPL Source Switch IFM Bypass

OBJECTIVE: Regain failed MMU1 (2) IPL Source switch function on panel O6.

LOCATION: AV BAY 1 (2)

- Remove locker MF43K (MF57K)
- Locate appropriate bracket A60J1 (A61J1) and connector P104
- Locate appropriate wire

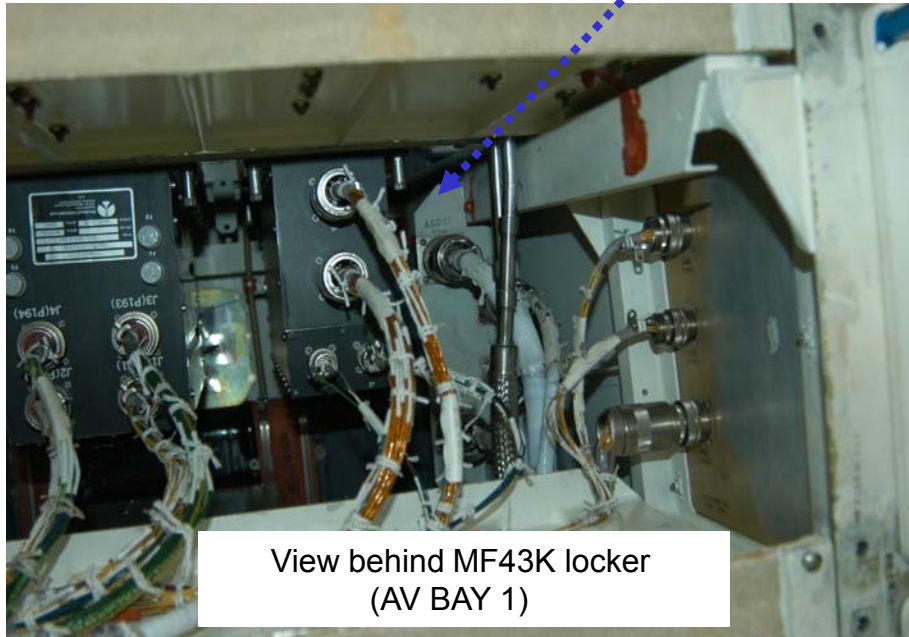

View behind MF43K locker
(AV BAY 1)

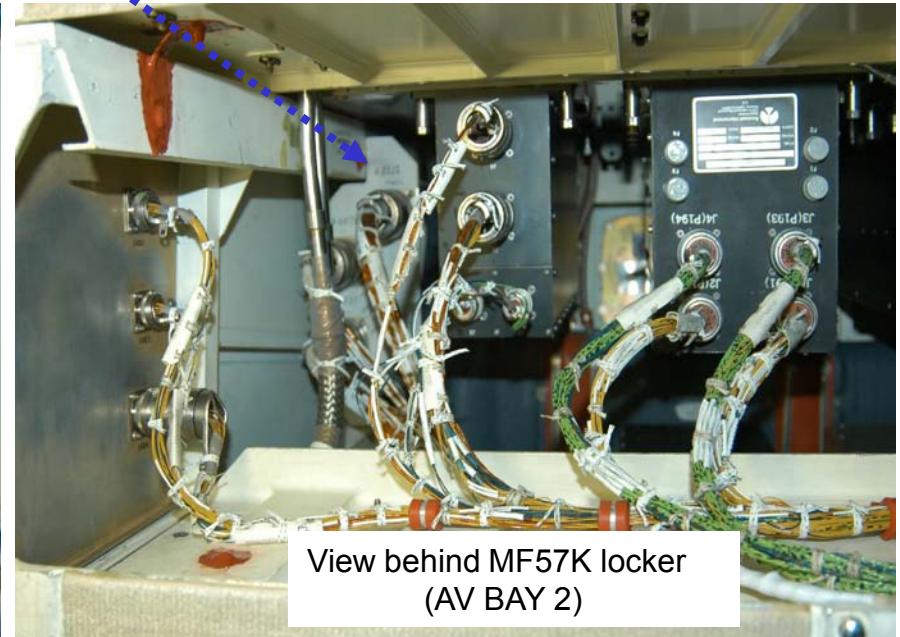

View behind MF57K locker
(AV BAY 2)

IPL Source Switch IFM Bypass

- Cut wire
- Ground True Line (to structure) and open Complement Line

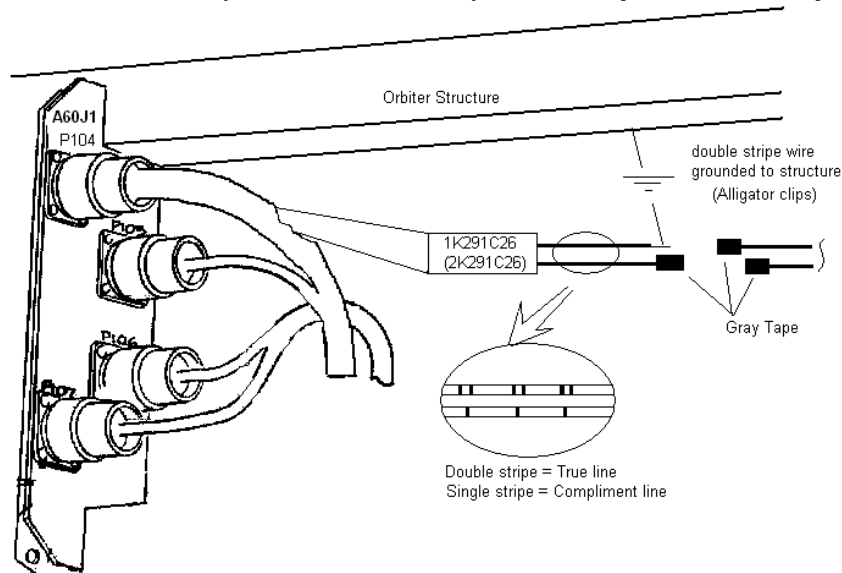

After IPL is done

- Ground Compliment Line and open True Line
(this takes the switch to the OFF position)

IPL Source Switch (O6 Panel)

